

KERA.PRO  
JUNCTION 45°

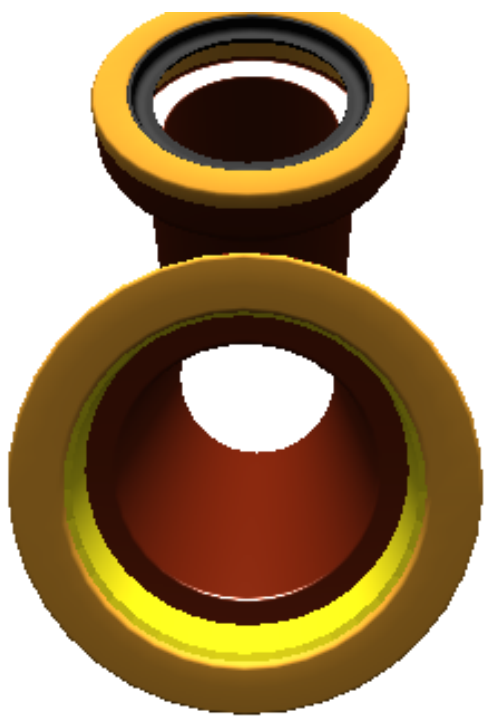

TECHNICAL DRAWING

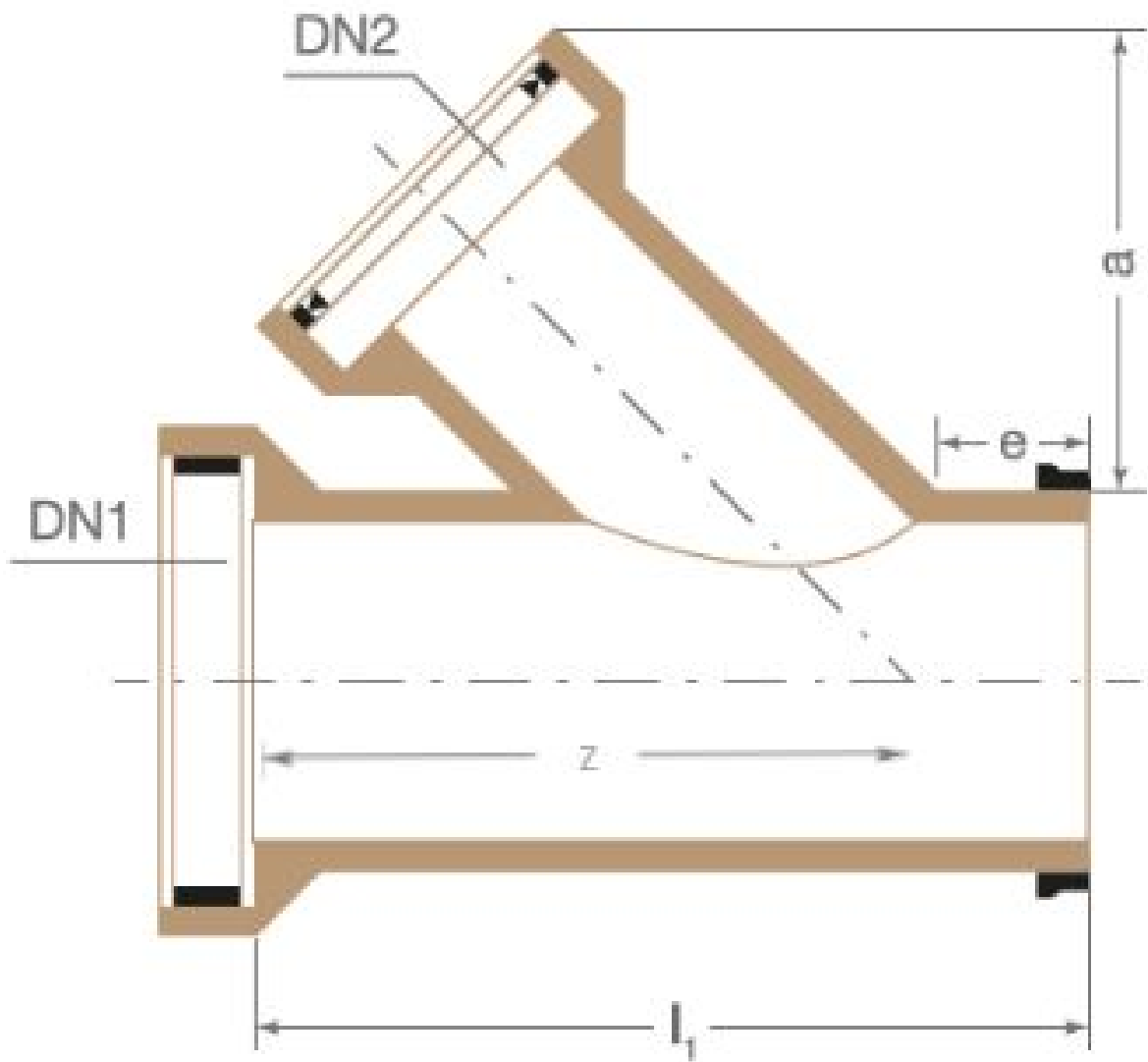

NOMINAL SIZE DN1 200

200	250	300
-----	-----	-----

NOMINAL SIZES DN2

150	200
-----	-----

JOINT DN1/DN2

KK	KL
----	----

LENGTH (CM)

60

WEIGHT  
42 kg/piece

TKL  
240/200

MEASUREMENTS

Nominal size	Branch size	Dimensions		
DN 1	DN 2	z max. mm	e max. mm	a max. mm
200	200	435	85	350

BRIEF DESCRIPTION

Angle  $\pm 5^\circ$

The dimensions z, a and e are reference values. Other dimensions and crushing strengths: see pipes. The strength class of the branch piece is always normal strength.

Vitrified clay pipes and fittings are standardised in EN 295-1. Supplementary requirements defines the certification program ZP WN 295. All measurements - especially when connecting to other products - must be checked and depend on the specifications of EN 295 and on the certification program ZP WN 295. Subject to technical changes.

